



User Manual

HogPlay Plus Media

Important Note: When First connecting to a new screen device will reboot to adjust resolution.

Insert the TF / Micro SD card as depicted in the illustration. Incorrect insertion may damage the product's card slot.

Thankyou for choosing HogPlay the leading only motorcycle media company on the market! Please read this user manual carefully before operating your new HogPlay Media device. HogPlay Media box's are not intended to enable video in motion. User should always engage in safe operation and never operate video while the vehicle is in motion. Doing so is strictly prohibited and is against the law. Please be safe and use video / entertainment options when parked.



HogPlay Media Box



USB A to C Cable



C to C Cable

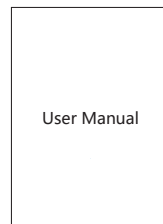

User Manual

Product Overview

Your HogPlay Media box can convert the original radio's wired CarPlay/Android Auto to wireless CarPlay/Android Auto. It seamlessly integrates iOS/Android with radios existing screen. Additionally, it supports multimedia systems, enabling you to watch videos on YouTube and Netflix directly on your existing motorcycle screen.

Key Features

1. Supports wireless CarPlay/Android Auto, allowing for direct connection to your phone each time you enter the vehicle, which is significantly more convenient than wired CarPlay/Android Auto.
2. Connect to a mobile hotspot to enjoy your favorite videos on YouTube and Netflix when parked or not in motion.
3. Supports video and lossless music playback from a TF / Micros SD card.
4. Wireless CarPlay facilitates music playback, navigation, and Siri usage. Wireless Android Auto supports navigation, music playback, and Google Voice.
5. [An optional dual WiFi device enables simultaneous connection to wireless CarPlay/wireless Android Auto and YouTube/Netflix.](#)

Compatibility Motorcycles and Phones

- Compatible Vehicles: HogPlay is compatible with most major Motorcycle brands w/ existing wired carplay.
- iPhone: Supports iPhone 6 and above, running iOS 10 or later
- Android Phones: Android 10.0 and above, with some requiring Android 11.0 or later.

Technical Specifications

System	Android 12				
Bluetooth Version	4.2 (for connecting wireless CarPlay)				
WiFi (single WiFi device)	5.8GHz (for connecting wireless CarPlay/Android Auto)				
Apps (factory installed)	Apple CarPlay , Android Auto , Screen Mirroring (Apple devices & select Android w/ app) , Netflix , Youtube , Media playback (Music/Movies/Images)				
CPU	Quad-core A53	Storage	2GB+16GB	Input	5V === 1A

Product Instructions

1. Connect HogPlay to the motorcycles USB /CarPlay interface and wait for HogPlay loading screen to appear.

First boot cycle will adjust resolution and reboot.

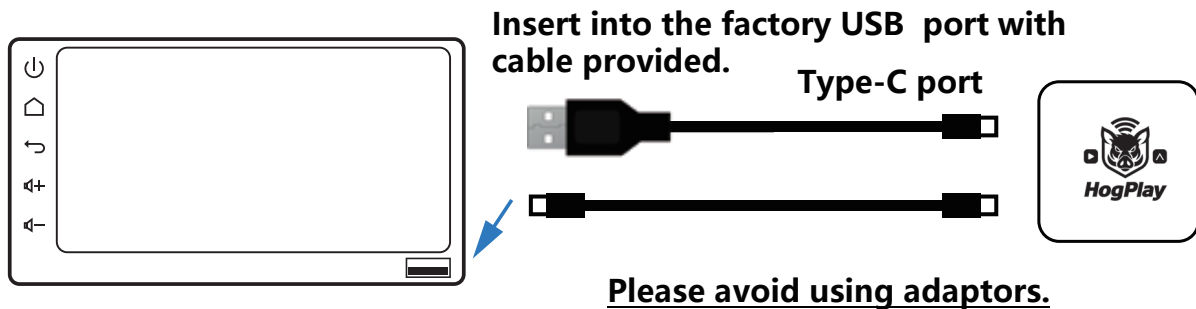

Only HogPlay approved USB cables should be used. Utilizing aftermarket cables may result in unstable performance.

2. HogPlay Main Interface:

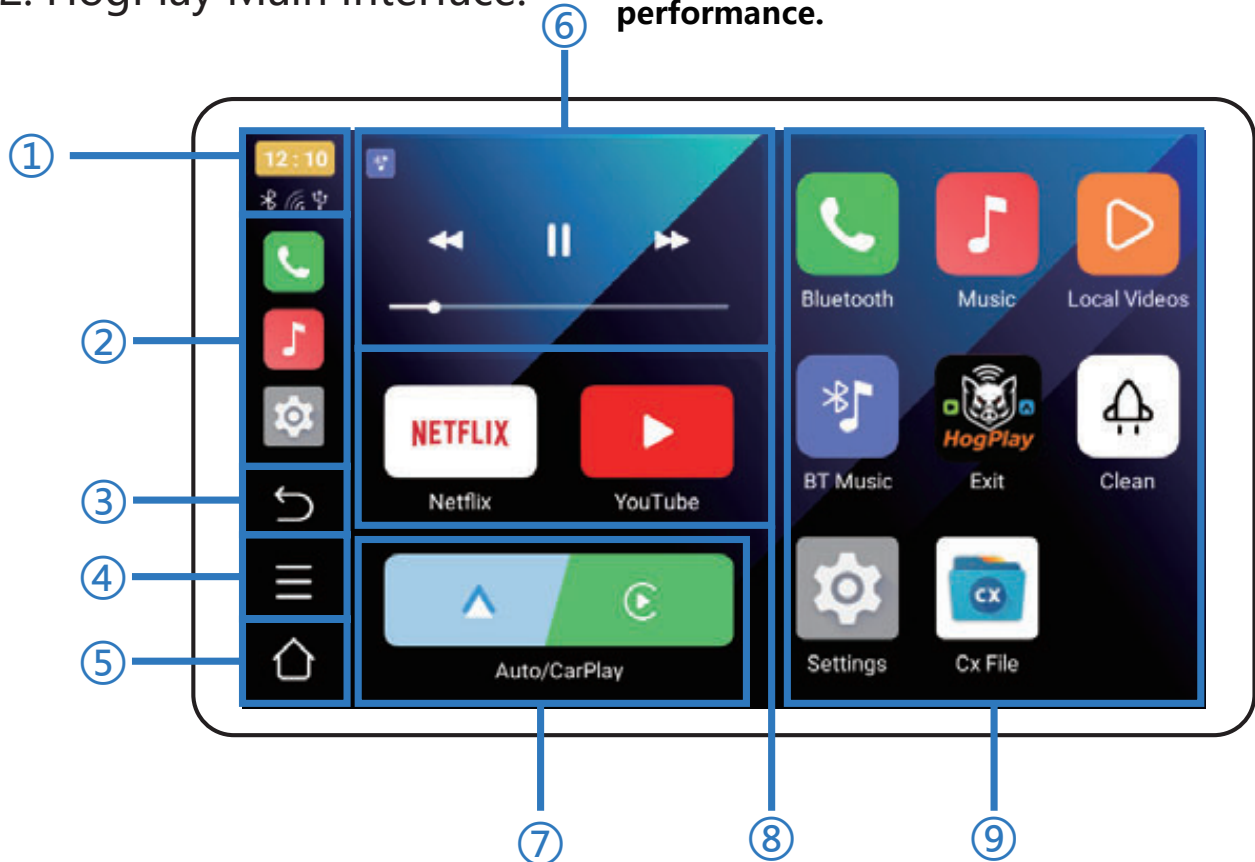



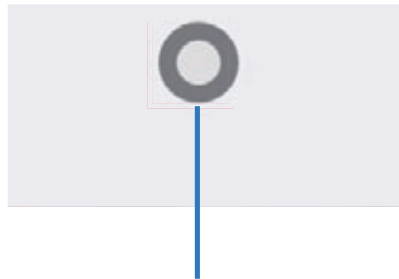

- ① Time/Connection Status
- ② Recently Used Apps
- ③ Back Button
- ④ Enter Background Programs
- ⑤ Return to Main Interface
- ⑥ Music Widget
- ⑦ Auto/CarPlay
- ⑧ Netflix/YouTube
- ⑨ Apps

Touch Assistant Usage

In third-party applications, tap the screen to summon the touch assistant (white floating ball)



Touch assistant

	Back Button	Return to the previous layer
	Program Background	Enter background programs
	Home Button	Return to the main interface
	Clear Background Programs	Clear background programs
	Return to Factory Screen	Return to the factory system

Wireless CarPlay/Android Auto Connection

1.Enable WiFi and Bluetooth on your phone

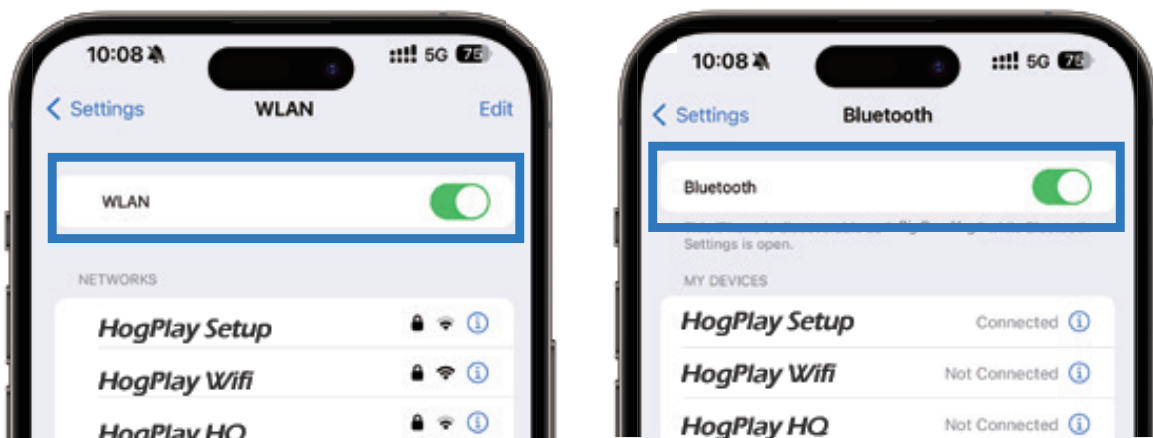

2. Tap the Auto/CarPlay icon on the interface to enter the connection screen.



3. Pair the box with your phone's Bluetooth HogPlay-XXXX.



4. Once the Bluetooth connection is successful, a CarPlay/Android Auto window will pop up on your phone. Click to enter the CarPlay/Android Auto interface.



When Playing back Youtube / Netflix its necessary to be connected to a seperate wifi network or hotspot and disconnect device from CarPlay/Android Auto before connecting to WiFi to play YouTube/Netflix.

How to Play YouTube/Netflix

1. Disconnect device from wireless CarPlay/Android Auto (phone's Bluetooth & WiFi)

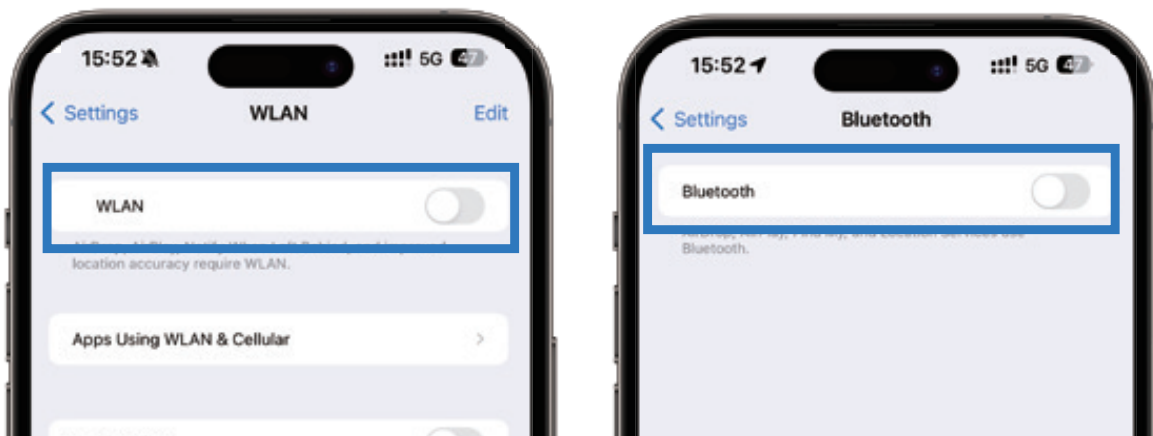

2.Connect to WiFi

Path: Click Settings - Network & Internet - Internet.



3.Play YouTube/Netflix

Note: This device does not support simultaneous use of wireless

CarPlay/Android Auto and YouTube/Netflix phone must be disconnected before use or your HogPlay Media Box needs to be connected to a separate wireless network.

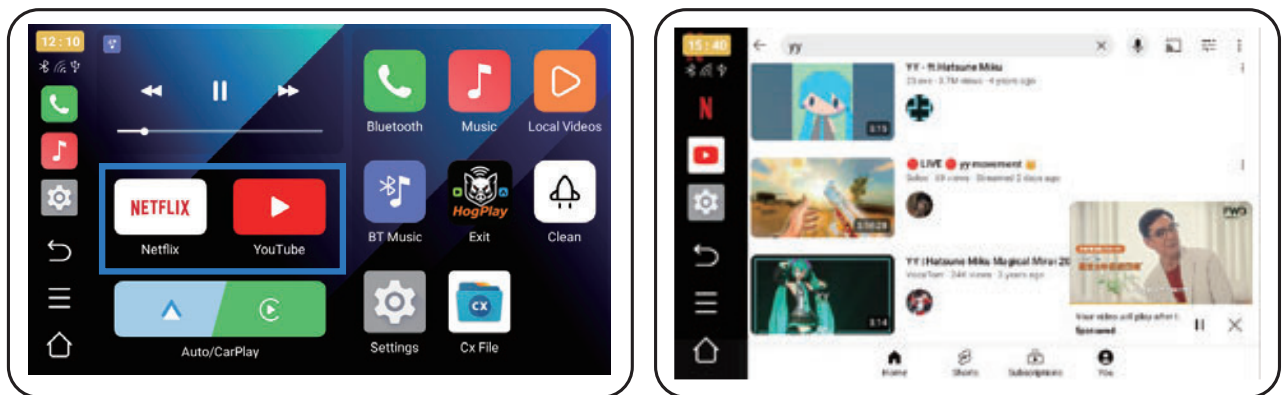

DO NOT PLAY VIDEO IN MOTION

This device does not support simultaneous use of wireless carplay and android auto while using Youtube or Netflix.

Always operate video playback safely, only when parked.

Personalized Settings

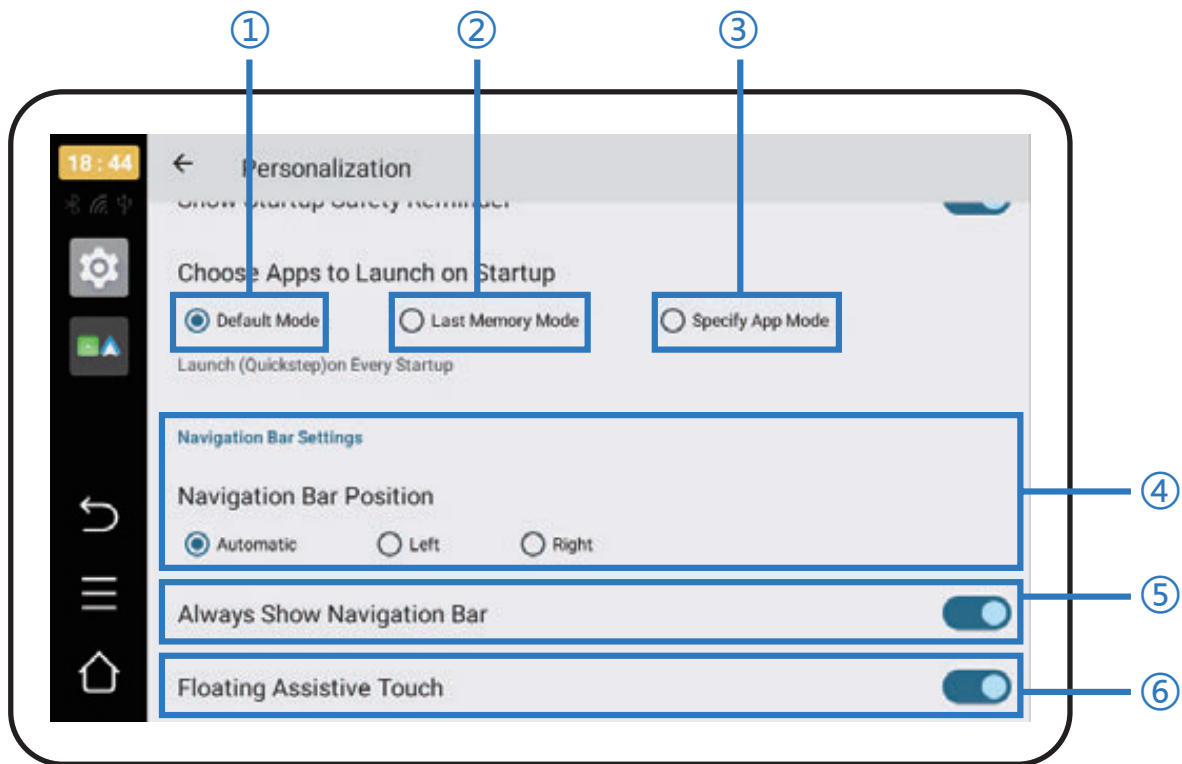

- ① Enter the main interface after booting
- ② Boot into the last used application before shutdown
- ③ Boot to select a specified application
- ④ Set the navigation bar to the left or right
- ⑤ Turn the navigation bar on/off
- ⑥ Turn the touch assistant on/off

How to Change Language

Path: Click Settings - System - Language & Input - Language
(drag the desired language to the top)

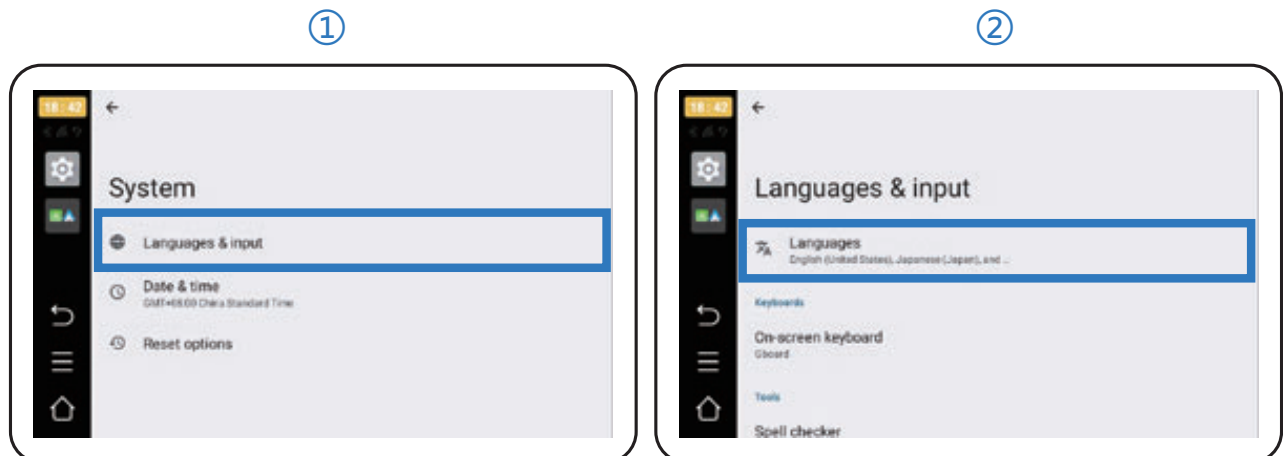

System Upgrade

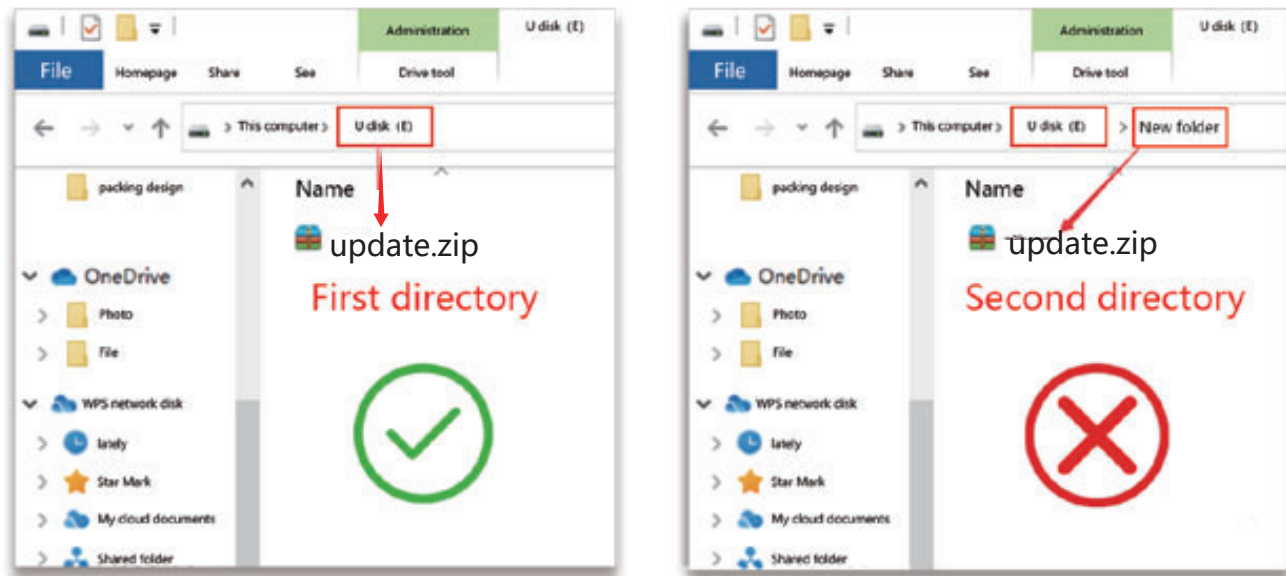

Only used approved HogPlay Media updates provided by support

First, download the upgrade file to the memory card. Do not unzip it, do not change its name, and do not create any new folders. Insert the card into your HogPlay Media box, and the system will load the update file and ask for confirmation. When the confirmation update system page pops up, click confirm, and wait for the update progress bar to complete. HogPlay will automatically restart. After the upgrade, be sure to remove the update card to prevent additional resets.

Indicator Light Status

- 1. Power Indicator (red light): The power indicator will stay on once the box is powered via USB.
- 2. Status Indicator (blue light): The status indicator stays on after the system starts.
- 3. Upgrade Status: Red/blue light flashes.
- 4. Upgrade Complete: White light stays on, waiting to restart.

Frequently Asked Questions

Q: Why doesn't HogPlay connect?

A: Please check the USB port you are connecting to and ensure it has wired CarPlay. Only use approved HogPlay Media Cables

Q: The car box cannot connect to the car and frequently disconnects.

A: ① Unpair the Bluetooth connection between your phone and the original radio screen.

② For select vehicles, the USB power supply is insufficient; you can purchase an additional power y cable from HogPlay.

③ Reset the original radio screen to factory settings, then reconnect your HogPlay Media Box from start.

Q: CarPlay/Android Auto cannot connect to your phone

A: ① Enable WiFi and Bluetooth on your phone, and ensure WiFi is not occupied by other devices. If it takes a long time to connect, manually select the device's hotspot from the WiFi list.

② Clear the phone' s Bluetooth records and reconnect the phone' s Bluetooth

Q: HogPlay shows a black screen on startup.

A: Set it to Engineering Mode - Delayed Start. After setting, unplug and replug the box to take effect. Please try until the issue is resolved or improved.

Q: The picture is not smooth/clear

A: Set it to Engineering Mode - Picture Smoothness. After setting, unplug and replug the box to take effect. Please try until the issue is resolved or improved.

Q: HogPlay Media Box's sound is stuttering

A: Set it to Engineering Mode - Choose Others. After setting, unplug and replug the box to take effect.

Q: Following the procedures did not solve my problem

A1: Set it to Engineering Mode - Auto Copy Logs to External Storage - Turn on. Insert a TF card into the device, and it will automatically copy the logs. Then, send the "Autolog" folder from the TF card to our technical staff. (Both auto and manual log copying functions can follow this step).

A2: Connect the device to a WiFi network, set it to Engineering Mode - Submit Logs - Take a photo of the screen after submission and send it to the technical staff.

A3: Once the technical staff receives the log file, they will handle your issue as soon as possible. Please be patient.

